

TOILET  
SEACOCK  
INLET OH

TOILET  
SEACOCK  
OUTLET OH

SHOWER  
& SINK DRAIN  
SEACOCK

12mm T

3/4\"/>

WASH  
BASIN

3/4\"/>

SHOWER  
DRAIN

Wp

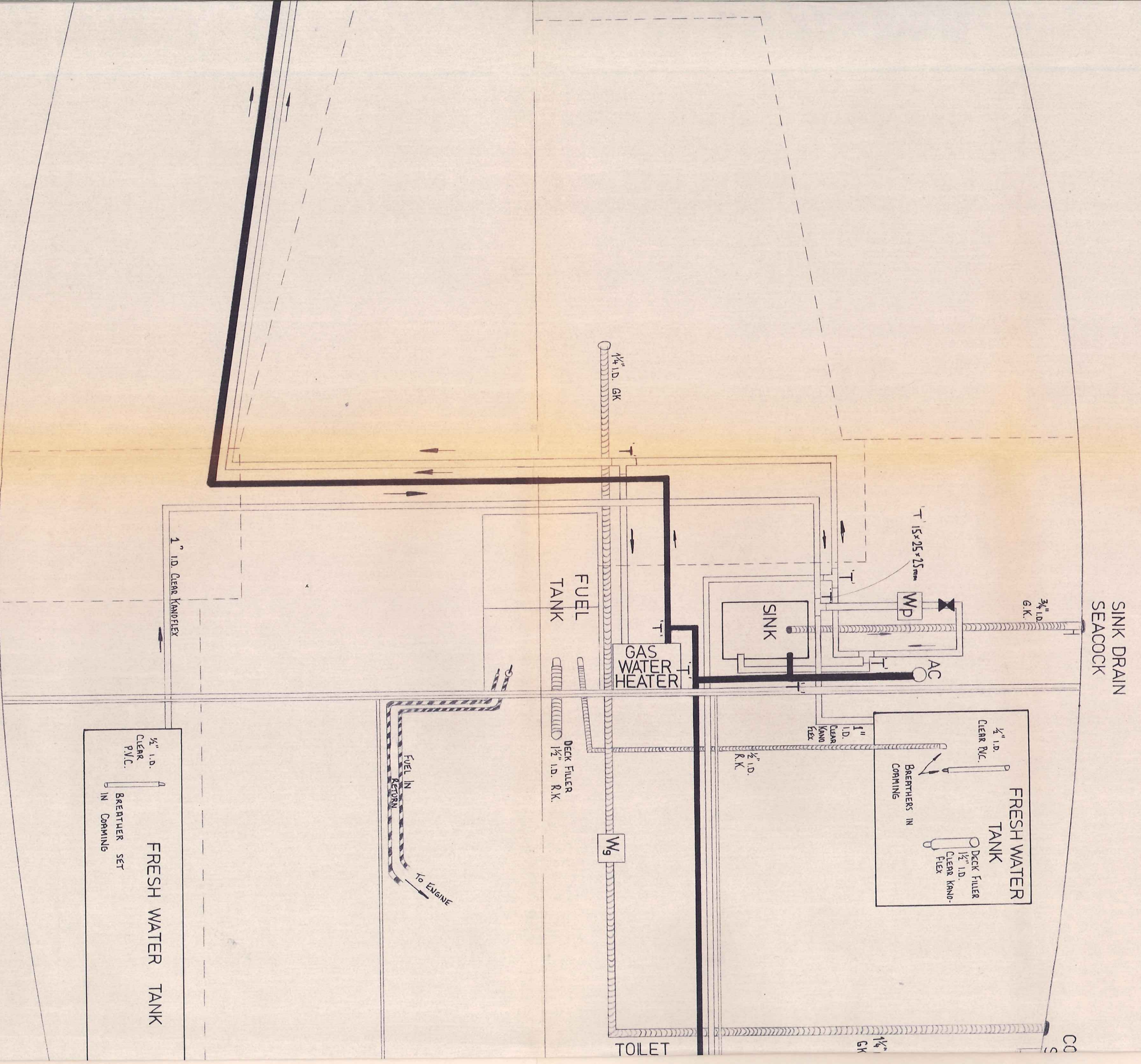

CKPIT DRAIN  
EACOCKS

SEACOCK  
INLET

- ==== COLD WATER SYSTEM 1/2" ID. CLEAR PVC. (UNLESS STATED)
- ===== HOT WATER SYSTEM 1/2" ID BLACK RUBBER
- W<sub>9</sub> WHALE GUSHER 10 to 18 GALLONS PER MINUTE
- ✕ NON RETURN VALVE FITTED VEX
- ▨ COPPER PIPE 5/16"

T' T CONNECTIONS 15 x 15 x 15 mm UNLESS STATED  
 WP WATER PUMP SELF PRIMING  
 2 1/2 GALLONS PER MINUTE

AC AIR ACCUMULATOR (PRESSURE MONITOR)  
 (G.K., R.K.) GREEN OR RED KANOFLEX

SHOWER &  
SINK DRAIN  
SEACOCK

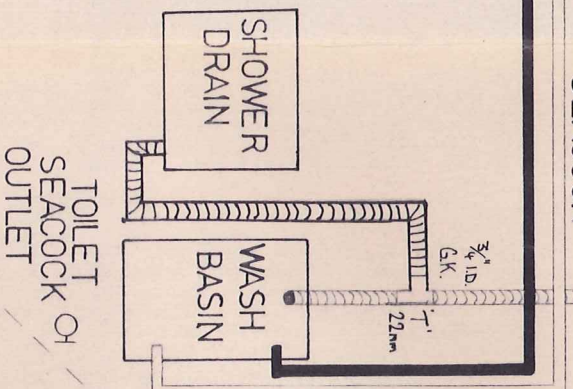

TOILET  
SEACOCK  
OUTLET

MARINE PROJECTS (PLYMOUTH) LTD JAN '79  
 MOODY 36  
 BILGE PUMP / HOT & COLD WATER / FUEL SYSTEMS  
 DRAWN BY M HOBSON  
 DRWG N° M36-030